

PRESSURE TRANSMITTER ATM

**23**

Features

- Compact and robust stainless steel assembly 1.4435 (316L)
- Piezoresistive measuring element
- Gauge, absolute or sealed gauge
- Standard DIN pressure ranges from 0...100 mbar to 0...1000 bar
- Calibration available for all common pressure units
- Complies with the EMC directive EN 61000
- Reverse polarity and short circuit protected
- Media temperature up to 150°C (option)
- Surge (lightning) protection according to EN 61000-4-5 (option)

Typical applications

- Machine installations
- Industrial process control
- Heating and ventilation
- Environmental monitoring
- Food industry
- Mobile hydraulics
- Test and calibration systems

Specifications

Pressure range	[bar]	0.1 ... 0.5	> 0.5 ... 2	> 2 ... 25	> 25 ... 600	> 600 ... 1000
Overpressure		3 bar	3 x FS (min. 3 bar)	3 x FS	3 x FS (max. 850 bar, optional 1500 bar)	1500 bar
Burst pressure	[bar]	> 200	> 200	> 200	> 850 (optional 1500 bar)	> 1500
Accuracy ¹⁾	[± % FS]	≤ 0.5 (optional ≤ 0.25)	≤ 0.5 (optional ≤ 0.25, ≤ 0.1)	≤ 0.5 (optional ≤ 0.25, ≤ 0.1)	≤ 0.5 (optional ≤ 0.25, ≤ 0.1)	≤ 1 (optional ≤ 0.5, ≤ 0.25)
Thermal shift	[± % FS/°C]					
Zero	0...70°C	0.06	0.03	0.015	0.015	0.015
	-25...85°C	0.08	0.04	0.02	0.02	0.02
Span	0...70°C	0.015	0.015	0.015	0.015	0.015
	-25...85°C	0.02	0.02	0.02	0.02	0.02
Response time		< 1 ms/10...90% FS				
Long term stability (1 year) - (typ./max.)		<0.5% FS/<4 mbar	<0.2% FS/<4 mbar	<0.1% FS/<0.2% FS	<0.1% FS/<0.2% FS	<0.1% FS/<0.2% FS

¹⁾ Zero based non-conformity according to DIN 16086, including hysteresis and repeatability

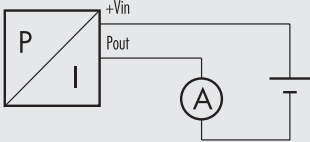
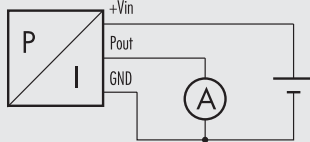
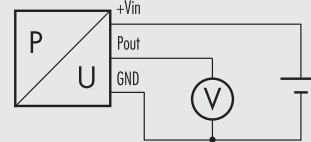
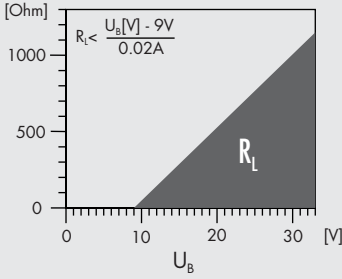
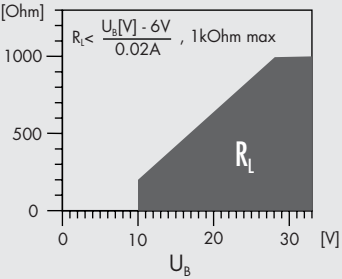
Output signal	4 ... 20 mA	0 ... 20 mA	0 ... 5 V / 0 ... 10 V
Type	Two wire current transmitter	Three wire current transmitter	Three wire voltage transmitter
Supply voltage	9...33 V DC	9...33 V DC	15...30 V DC
Supply voltage influence	< 0.1% FS	< 0.1% FS	< 0.1% FS
Circuit diagram			
Load resistance			$R_L > 10k\Omega$
Load resistance influence	< 0.1% FS	< 0.1% FS	< 0.1% FS

Materials

Process connection, diaphragm, housing Stainless steel 1.4435 (316L) other materials (e.g. titanium) on request
Seals (standard) Viton (other materials see ordering information)

Electromagnetic compatibility

Standard	Level	Typical interferences	
Emission:			
EN 61000-6-3 EN 55022	Generic emission standard Emission, class B		
Immunity:			
EN 61000-6-2	Generic immunity		
EN 61000-4-2	Electrostatic discharge	4kV contact, 8kV air	
EN 61000-4-3	Radiated electro-magnetic field	10V/m, 80-1000 MHz, 80% AM 1kHz	Cellular phones, radio sets
EN 61000-4-3	Radiated electro-magnetic field (GSM)	10V/m, 950 MHz, 200Hz on/off	Digital portable phones
EN 61000-4-4	Fast transients (burst)	2 kV	Motors, valves
EN 61000-4-6	Conducted radio-frequency	10V, 0.15-80 MHz, 80% AM 1kHz	Cellular phones, radio sets
EN 61000-4-5	Surge	10 kA (8/20 ms) ²⁾	Lightning strikes

²⁾ Only with optional surge (lightning) protection



The pressure transmitter ATM fulfils the emission and immunity requirements described in the EMC directive EN 61000.

Ordering Information

23 X . XXXX . XXXX . XX . XXX

Type	ATM	23					
Pressure type	Gauge	1					
	Absolute	2					
	Sealed gauge	3					
Pressure range	0...100 mbar		00				
	0...160 mbar		01				
	0...250 mbar		02				
	0...400 mbar		03				
	0...600 mbar		04				
	0...1.0 bar		05				
	0...1.6 bar		06				
	0...2.5 bar		07				
	0...4.0 bar		08				
	0...6.0 bar		09				
	0...10 bar		10				
	0...16 bar		11				
	0...25 bar		12				
	0...40 bar		3	13			
	0...60 bar		3	14			
	0...100 bar		3	15			
	0...160 bar		3	16			
	0...250 bar		3	17			
	0...400 bar		3	18			
	0...600 bar		3	19			
0...1000 bar		3	20				
Special calibration			99				
Process connection	G 1/4 female (Fig. 1)			00			
	G 1/4 M (Fig. 2)			11			
	G 1/4 M, Manometer DIN 16288 (Fig. 3)			12			
	G 1/2 M (Fig. 4)			13			
	G 1/2 M, frontal diaphragm (Fig. 5)			14			
	G 1/2 M, flush diaphragm (Fig. 6)			15			
	G 1/2 M, Manometer DIN 16288 (Fig. 7)			16			
	1/4 NPT M			10			
	1/2 NPT M (Fig. 8)			19			
	Special process connection			99			
Electrical connection	Connector DIN 43650 (screwed on ³⁾) ⁵⁾ (Fig. 10)	IP 65			01		
	Connector Binder 723, 5-pin ⁵⁾ (Fig. 11)	IP 67			03		
	Connector Binder 723, 5-pin (screwed on ³⁾) ⁵⁾ (Fig. 12)	IP 67			43		
	Connector MIL C26482, (10-6) ⁵⁾ (Fig. 13)	IP 40			06		
	PE cable ^{6) 7) 8)} (Fig. 14)	IP 67			13		
	PUR cable ^{6) 7)} (Fig. 14)	IP 67			15		
	Teflon cable ⁶⁾ (Fig. 14)	IP 67			21		
Special electrical connection				99			
Output signal	0... 5 V DC				46		
	0... 10 V DC				47		
	0...20 mA				00		
	4...20 mA				05		
	4...20 mA surge (lightning) protection				08		
	0... 10 V DC surge (lightning) protection				49		
	Special output signal				99		
Accuracy	≤ ± 0.5 % FS					0	
	≤ ± 0.25 % FS					1	
	≤ ± 0.1 % FS (on request)					2	
Temperature range	Compensated 0...70°C (medium temperature 0... 80°C)					0	
	Compensated -25...85°C (medium temperature -25...100°C) ⁷⁾					1	
	Compensated -25...85°C (medium temperature -25...150°C) ⁷⁾					2	
	Special temperature range					9	
Options	Throttle ⁴⁾						A
	Electronics packed in gel: Gauge pressure						C
	Absolute and sealed gauge pressure						D
	Special oil filling in the TD: ASEOL Food						G
	Halocarbon						H
	Seals: Viton (Standard)						U
	EPDM						S
	Kalrez						T
Special options						Z	

³⁾ Zero offset and span adjustable

⁴⁾ Available only with fig. 2, fig. 4 or fig. 7

⁵⁾ Cable socket connector not included

⁶⁾ Please specify the required cable length

⁷⁾ For medium temperature > 50°C a teflon cable must be used

⁸⁾ Suitable for drinking water (food approved)

Pressure Connection

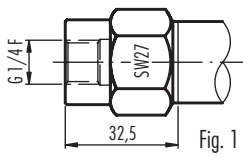

Fig. 1

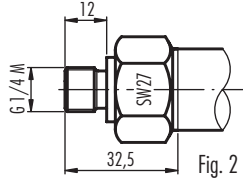

Fig. 2

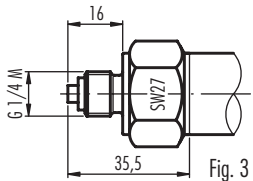

Fig. 3

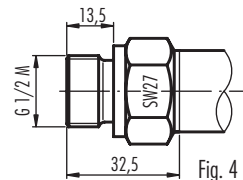

Fig. 4

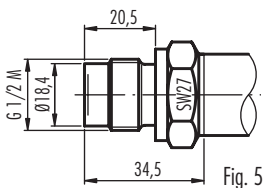

Fig. 5

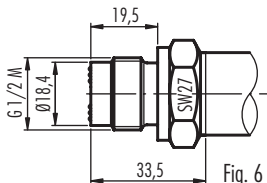

Fig. 6

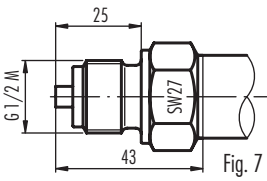

Fig. 7

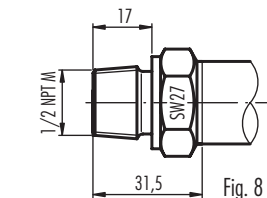
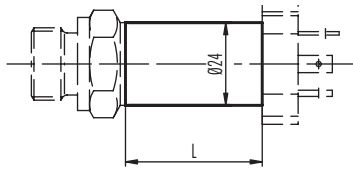

Fig. 8

Dimensions

Version for medium temperature up to 100°C



L = 40 mm for connector DIN 43650 (Fig. 10)
L = 45 mm for all other versions
L = 94 mm for version with surge (lightning) protection

Version for medium temperature up to 150°C

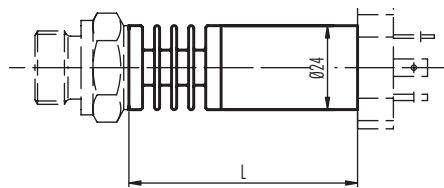

L = 67 mm for connector DIN 43650 (Fig. 10)
L = 72 mm for all other versions
L = 121 mm for version with surge (lightning) protection

Electrical Connection

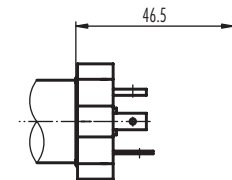

Fig. 10

Pin	2-Wire	3-Wire
1	+Vin	+Vin
2	Pout	Pout
3		GND

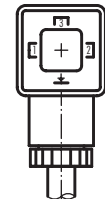

Fig. 11

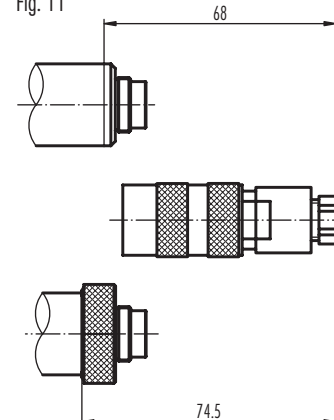
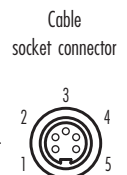

Fig. 12



Pin	2-Wire	3-Wire
1	Pout	Pout
3	+Vin	+Vin
4		GND

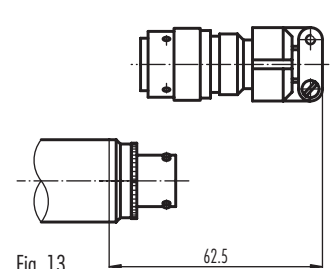
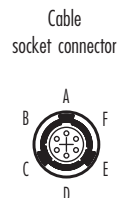

Fig. 13



Pin	2-Wire	3-Wire
A	+Vin	+Vin
B		GND
C	Pout	Pout

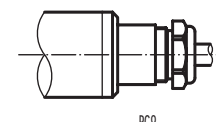

Fig. 14

Colour	2-Wire	3-Wire
white	+Vin	+Vin
yellow	Pout	GND
brown		Pout

Specifications may change without notice.

Switzerland

STS Sensor Technik Sirnach AG
Rüthofstrasse 8
CH - 8370 Sirnach
Tel.: +41 (0)71 969 49 29
Fax: +41 (0)71 969 49 20
e-mail: sales@sts-ag.ch
Internet: www.sts-ag.ch

Germany

STS Sensoren Transmitter Systeme GmbH
Mercedesstrasse 1
D - 71063 Sindelfingen
Tel.: +49 (0)7031 811 920
Fax: +49 (0)7031 811 958
e-mail: sts.gmbh@t-online.de
Internet: www.sts-ag.ch

Italy

STS Italia s.r.l.
Via Gesù 5
I - 20090 Opera (MI)
Tel.: +39 02 57607073/074
Fax: +39 02 57607110
e-mail: stsopera@tin.it
Internet: www.sts-ag.ch

France

STS France
66, Avenue de la Gare
FR - 74100 Annemasse
Tel.: +33 (0)4 5037 6925
Fax: +33 (0)4 5039 4225
e-mail: info@stsfrence.fr
Internet: www.sts-ag.ch

DED011A

Release 02/2003